

# Remote Controller (RC-15-F1)

The Remote Controller is used to arm the system in home or away mode, disarm the system and send a panic signal.

## ● Identifying the parts

Press and hold each key to activate its functions described below:

### 1. **BUTTON**

Pressing this button will arm the system in away mode.

### 2. **BUTTON**

Pressing and holding this button for three seconds will send a panic signal, regardless of system status (armed or disarmed). If the 3 seconds time is not reached, the Emergency activation will fail.

### 3. **BUTTON**

Pressing this button will arm the system in home mode.

### 4. **BUTTON**

Pressing this button will disarm the system. If the alarm is sounding, pressing this button will stop the alarm (except when the alarm was raised by pressing the Remote Controller's Panic button)

### 5. **LED INDICATOR**

The LED will flash quickly when the Away Arm, Home Arm and Disarm buttons are pressed.

When the Panic Button is pressed, the LED will first flash slowly for 3 seconds, then flashes quickly for 3 seconds and turn on for 1 second.

### 6. **BATTERY COMPARTMENT**

The RC-15 uses one "CR2032" 3V Lithium battery as its power source. The low battery status will be sent to the Control Panel along with regular signal transmission, and, the Control Panel will display the status accordingly.

#### <NOTE>

- ☞ When changing battery, after removing the old battery, press any button twice to fully discharge before inserting new battery.
- ☞ When a low voltage battery is inserted, the LED will flash 3 times to indicate low battery.

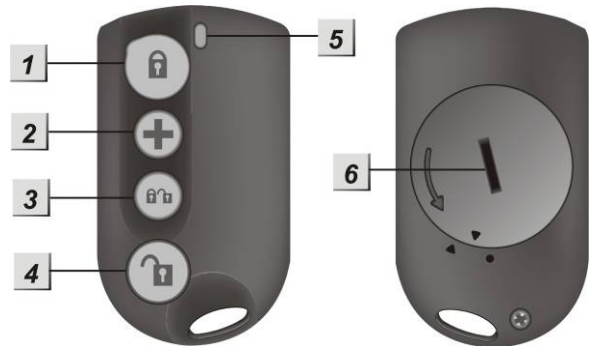

## ● Getting Started

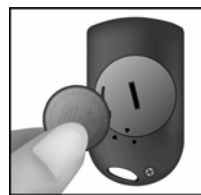
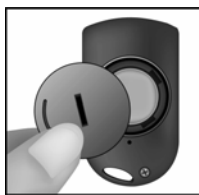
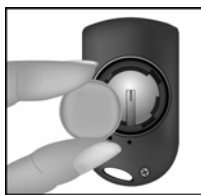

- Remove the battery cover by using a coin to turn it counter-clockwise
- Insert the battery as shown in the diagram, with the unmarked side (negative) of the battery facing down
- Replace the battery cover
- Secure the cover by using a coin to turn clockwise
- Put the Control Panel into "**Device +/-**" menu and then select "**Add Device**" menu.
- Press any buttons on the Remote Controller.
- Please refer to the operation manual of your control panel under the section of "**Device +/-**" to complete learn-in process.